

## Papuci cupru tubulari



- Papuci cupru 0.75 - 630 mm<sup>2</sup>, conform STAS



- pentru conductoare multifilare



## Caracteristici

- Cu gaura de inspectie
- Tratat prin reoacere pt. optimizarea proprietatilor materialului si a sertizarii
- Executat după cote stricte pentru obtinerea unui contact electric perfect

## Material

- Cupru EN 13600

## Suprafata

- Stanata

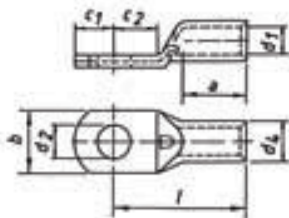

Secțiune mm <sup>2</sup>	Diam. gaură Ø	Cod	Dimensiune mm								Greutate/ 100 buc. ~ kg	buc/cutie
			d1	a	b	d2	d4	c1	c2	l		
0.75	M3	L0.75/3MS	1.3	6	6.0	3.2	2.8	3.25	4.0	12	0.060	100
	M4	L0.75/4MS	1.3	6	6.5	4.3	2.8	4.00	5.0	13	0.065	100
	M5	L0.75/5MS	1.3	6	7.5	5.3	2.8	4.75	6.0	14	0.065	100
1.5	M3	L1.5/3MS	1.8	6	6.5	3.2	3.3	3.25	4.0	12	0.075	100
	M4	L1.5/4MS	1.8	6	6.5	4.3	3.3	4.00	5.0	13	0.080	100
	M5	L1.5/5MS	1.8	6	7.5	5.3	3.3	4.75	5.5	14	0.085	100
	M6	L1.5/6MS	1.8	6	9.0	6.5	3.3	6.50	6.5	16	0.095	100
2.5	M3	L2.5/3MS	2.3	6	7.5	3.2	4.2	3.25	4.0	12	0.130	100
	M4	L2.5/4MS	2.3	6	7.5	4.3	4.2	4.00	5.0	13	0.130	100
	M5	L2.5/5MS	2.3	6	8.5	5.3	4.2	4.75	5.5	14	0.140	100
	M6	L2.5/6MS	2.3	6	9.5	6.5	4.2	6.50	7.0	16	0.150	100
	M8	L2.5/8MS	2.3	6	13.0	8.5	4.2	7.75	9.5	20	0.190	100
4	M4	L4/4MS	3.0	8	8.5	4.3	5.0	4.75	5.5	17	0.215	100
	M5	L4/5MS	3.0	8	9.0	5.3	5.0	4.75	6.0	17	0.215	100
	M6	L4/6MS	3.0	8	10.0	6.5	5.0	6.50	7.0	19	0.240	100
	M8	L4/8MS	3.0	8	13.0	8.5	5.0	8.50	9.5	22	0.280	100
6	M4	L6/4MS	4.0	9	9.5	4.3	6.0	5.00	5.5	18	0.290	100
	M5	L6/5MS	4.0	9	9.5	5.3	6.0	6.50	6.5	19	0.310	100
	M6	L6/6MS	4.0	9	10.0	6.5	6.0	7.00	7.0	19	0.310	100
	M8	L6/8MS	4.0	9	14.0	8.5	6.0	8.50	8.5	22	0.360	100
10	M5	L10/5MS	4.4	10	10.0	5.3	6.0	6.25	6.5	21	0.290	100
	M6	L10/6MS	4.4	10	10.0	6.5	6.0	7.00	7.0	21	0.290	100
	M8	L10/8MS	4.4	10	13.0	8.5	6.0	8.50	8.5	24	0.330	100
16	M6	L16/6MS	5.5	11	11.5	6.5	8.0	6.25	7.5	24	0.650	100
	M8	L16/8MS	5.5	11	14.0	8.5	8.0	8.50	9.5	27	0.740	100
	M10	L16/10MS	5.5	11	17.0	10.5	8.0	10.50	11.5	29	0.790	100
	M12	L16/12MS	5.5	11	19.0	13.0	8.0	12.00	13.0	31	0.800	100
25	M6	L25/6MS	6.8	12	13.0	6.5	9.0	7.50	7.5	26	0.750	100
	M8	L25/8MS	6.8	12	14.0	8.5	9.0	10.00	10.0	28	0.830	100
	M10	L25/10MS	6.8	12	17.0	10.5	9.0	12.00	12.0	31	0.900	100
	M12	L25/12MS	6.8	12	19.0	13.0	9.0	13.00	13.0	32	0.900	100
35	M6	L35/6MS	8.2	15	16.0	6.5	11.0	7.50	7.5	30	1.400	100
	M8	L35/8MS	8.2	15	16.0	8.5	11.0	10.00	10.0	32	1.450	100
	M10	L35/10MS	8.2	15	18.0	10.5	11.0	12.00	12.0	35	1.570	100
	M12	L35/12MS	8.2	15	19.0	13.0	11.0	13.00	13.0	36	1.570	100
	M14	L35/14MS	8.2	15	21.0	15.0	11.0	14.50	14.5	38	1.600	100

## Papuci cupru tubulari

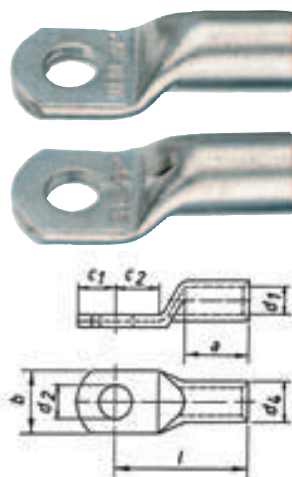

- Papuci cupru 0.75 - 630 mm<sup>2</sup>, conform STAS

- Cu gaura de inspectie
- Pentru conductoare multifilare din cupru
- Pentru conductoare sectoriale rotunjite din cupru

## Caracteristici

- Tratat prin recoacere pt. optimizarea proprietatilor materialului si a sertizarii
- Executat după cote stricte pentru obtinerea unui contact electric perfect

## Material

- Cupru EN 13600

## Suprafata

- Stanata

Secțiune mm <sup>2</sup>	Diam. gaură Ø	Cod	Dimensiune mm								Greutate/ 100 buc. ~ kg	buc/cutie
			d1	a	b	d2	d4	c1	c2	l		
50	M6	L50/6MS	9.5	18	18	6.5	12.0	7.5	7.5	36	1.58	100
	M8	L50/8MS	9.5	18	18	8.5	12.0	10.0	10.0	36	1.63	100
	M10	L50/10MS	9.5	18	18	10.5	12.0	12.0	12.0	38	1.73	100
	M12	L50/12MS	9.5	18	21	13.0	12.0	13.0	13.0	39	1.74	100
	M14	L50/14MS	9.5	18	21	15.0	12.0	14.5	14.5	42	1.80	100
	M16	L50/16MS	9.5	18	26	17.0	12.0	16.0	16.0	43	1.80	100
70	M8	L70/8MS	11.2	20	21	8.5	14.5	10.0	10.0	39	2.74	100
	M10	L70/10MS	11.2	20	21	10.5	14.5	12.0	12.0	41	2.90	100
	M12	L70/12MS	11.2	20	22	13.0	14.5	13.0	13.0	42	2.90	100
	M14	L70/14MS	11.2	20	23	15.0	14.5	14.5	14.5	45	3.00	100
	M16	L70/16MS	11.2	20	26	17.0	14.5	16.0	16.0	46	3.10	100
95	M10	L95/10MS	13.4	22	25	10.5	17.0	12.0	12.0	45	4.10	50
	M12	L95/12MS	13.4	22	25	13.0	17.0	13.0	13.0	47	4.20	50
	M14	L95/14MS	13.4	22	27	15.0	17.0	14.5	14.5	49	4.30	50
	M16	L95/16MS	13.4	22	27	17.0	17.0	16.0	16.0	51	4.40	50
120	M12	L120/12MS	15.0	26	28	13.0	19.5	14.0	14.0	51	6.45	50
	M16	L120/16MS	15.0	26	28	15.0	19.5	15.0	15.0	52	6.60	50
150	M12	L150/12MS	16.5	30	31	13.0	21.0	15.0	15.0	57	7.65	50
	M16	L150/16MS	16.5	30	31	17.0	21.0	16.0	16.0	58	7.85	50
185	M16	L185/16MS	19.0	30	35	17.0	24.0	18.0	18.0	65	11.40	50
	M20	L185/20MS	19.0	30	39	21.0	24.0	22.0	22.0	69	12.10	50
240	M16	L240/16MS	21.0	35	39	17.0	26.0	21.5	19.0	72	14.00	50
	M20	L240/20MS	21.0	35	39	21.0	26.0	21.5	19.0	72	14.40	50
300	M16	L300/16MS	23.5	44	43	17.0	29.5	24.0	24.0	87	23.80	25
	M20	L300/20MS	23.5	44	43	21.0	29.5	24.0	24.0	87	23.10	25
400	M16	L400/16MS	27.0	44	49	17.0	34.0	24.0	24.0	90	31.50	20
	M20	L400/20MS	27.0	44	49	21.0	34.0	24.0	24.0	90	32.50	20
500	M16	L500/16MS	31.0	68	56	17.0	38.0	24.0	24.0	120	46.00	10
	M20	L500/20MS	31.0	68	56	21.0	38.0	24.0	24.0	120	49.00	10
630	M16	L630/16MS	34.0	68	59	17.0	40.0	24.0	24.0	120	42.00	10
	M20	L630/20MS	34.0	68	59	21.0	40.0	24.0	24.0	120	45.00	10