



100



RIGOLE

SKIP 100

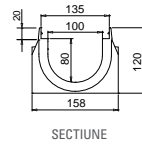
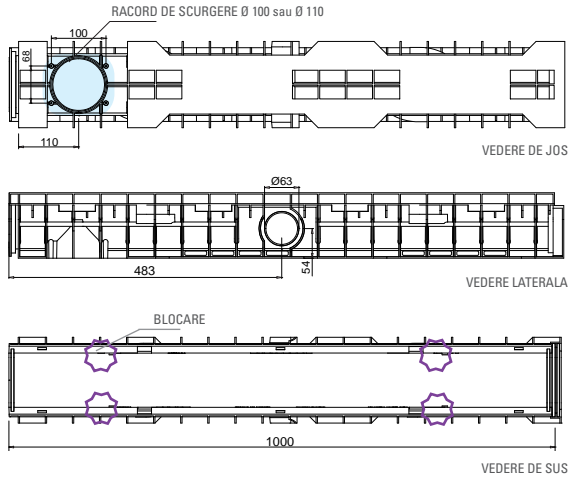

SKIP 100/80

COD	PRET	MATERIAL	DIMENSIUNI EXTERNA L x l x h	DIMENSIUNI INTERNE L x l x h	GREUTATE	SECTIUNE DRENARE	CAPACITATE	EVACUARI PREINSTALATE
	€		mm	mm	kg	cm ²	dm ³	mm
707000		PE-HD	1000 x 158 x 120	1000 x 100 x 80	1,75	69,28	6,92	lateral inferior*** 2 x Ø 63 1 x Ø 100; 1 x Ø 110

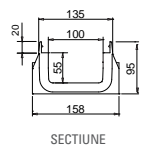
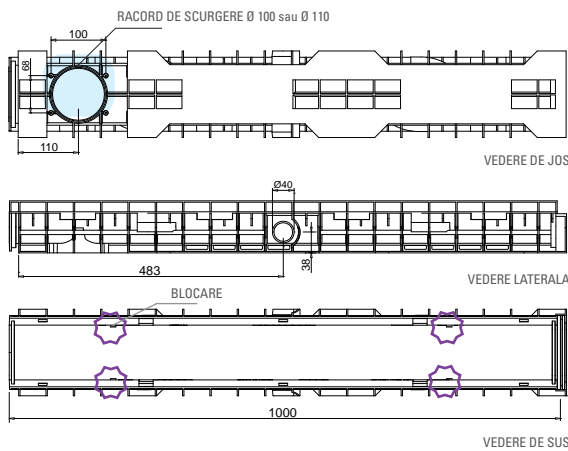

SKIP 100/55

COD	PRET	MATERIAL	DIMENSIUNI EXTERNA L x l x h	DIMENSIUNI INTERNE L x l x h	GREUTATE	SECTIUNE DRENARE	CAPACITATE	EVACUARI PREINSTALATE
	€		mm	mm	kg	cm ²	dm ³	mm
707001		PE-HD	1000 x 158 x 95	1000 x 100 x 55	1,55	54,44	5,44	lateral inferior*** 2 x Ø 40 1 x Ø 100; 1 x Ø 110

*** Pentru a obtine evacuarile dorite utilizati Kit Racorduri de evacuare (disponibile in doua versiuni Ø100 si Ø110).

§ Etansare: pentru asigurarea unei etansari perfecte a rigolei, va sfatuim sa utilizati un adeziv de etansare bituminos.

Pentru informatii suplimentare contactati Departamentul Tehnic.

NOTA: Dimensiunile si greutatile se incadreaza in limite normale de toleranta.



GRATARE



A 15

SKIP 100

APLICATII ZINCAT

Zone verzi, parcuri
Zone pietonale si/sau biciclisti
Stadioane
Terasse

APLICATII INOX INOX

Zone verzi, parcuri
Zone pietonale si/sau biciclisti
Stadioane
Terasse
Bucatarii spitale, restaurante si similare

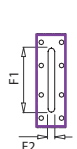

DETALIU FANTA

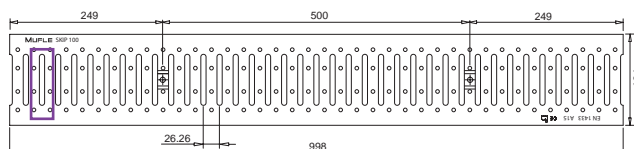

VEDERE DE SUS



VEDERE LATERALA

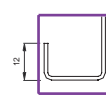

DETALIU INDOIRE

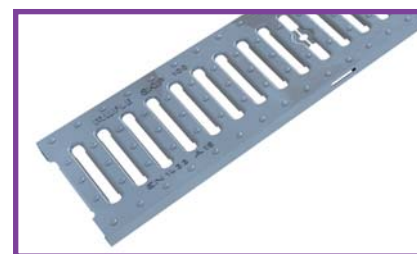

GRATAR STANTAT



COD	PRET €	MATERIAL	DIMENSIUNI L x l x h mm	GREUTATE kg	SUPRAFATA DRENARE dm ²	DESCHIDERE F1 x F2 mm	PRINDERE		
							bareta	clip	zimt (fara fixare)***
507122		otel DX51D** zincat	998 x 124 x 20	1,30	2,35	83,0 x 8,5			
507123		otel inox AISI 304* decapat							
507124		otel DX51D** zincat	498 x 124 x 20	0,65	1,175				
507125		otel inox AISI 304* decapat							

MONTARE GRATAR CU SISTEM CLIP

- Asezati gratarul pe rigola astfel incat sa corespunda fanta la carligul sistemului Clip SKIP si apasati cu un surubelnita pe bareta;
- Potriviti gratarul cu mana pana se realizeaza imbinarea.

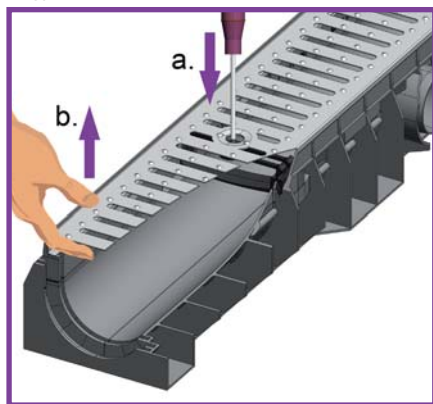

DEMONTAREA GRATARULUI

- Apasati cu un surubelnita pe sistemul Clip Skip in asa fel incat sa se produca decuplarea;
- Ridicati.

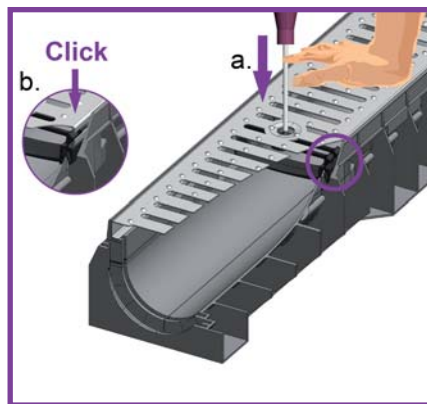

NEW

Gratarele stantate si din PE-HD SKIP se pot fixa mai rapid si mai sigur cu ajutorul sistemului Clip SKIP!!!

* Clasificare conform normei americane ASTM.

** Clasificare conform normei EN 10142 (ed.Luile 2002) si simbolistica conform normei EN 10027-1 (-2) (ed. septembrie 1993).

*** Sistem de blocare cu ajutorul unei protuberante continuta de rigola. Blocajul nu asigura fixarea gratarului pe rigola. Pentru obtinere unei prinderi stabile va sfatuim sa utilizati sistem de prindere cu bareta sau clip.

NOTA: Dimensiunile si greutatele se incadreaza in limite normale de toleranta.



GRATARE

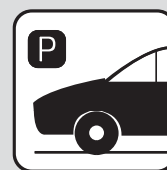

B 125

SKIP 100

APLICATII ZINCAT

Trotuare
Zone de stationare si parcuri private

APLICATII INOX

Trotuare
Zone de stationare si parcuri private
Industria alimentara
Medii chimic agresiv

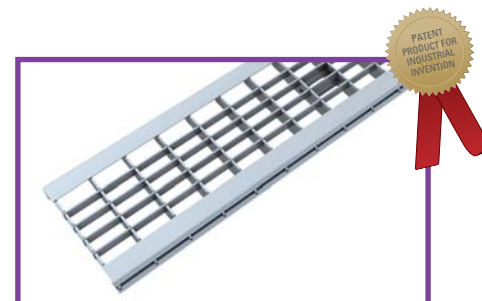
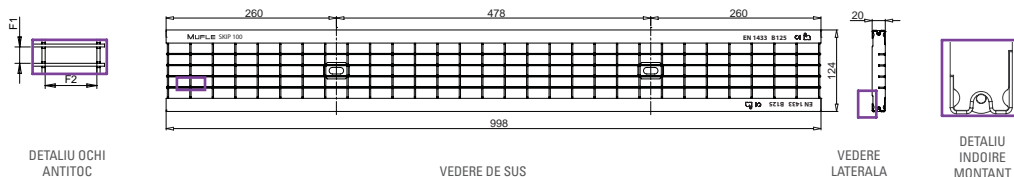

GRATAR FAGURE ANTITOC



COD	PRET €	MATERIAL	DIMENSIUNI L x l x h mm	GREUTATE kg	SUPRAFATA DRENARE dm ²	DESCHIDERE F1 x F2 mm	PRINDERE	
							bareta	zimt (fara fixare)***
507104		otel DD11 (1.0332)** zincat la cald	998 x 124 x 20	2,90	7,19	15,2 x 32,2		
507112		otel inox AISI 304* decapat						
507106		otel DD11 (1.0332)** zincat la cald	498 x 124 x 20	1,45	3,60			
507116		otel inox AISI 304* decapat						

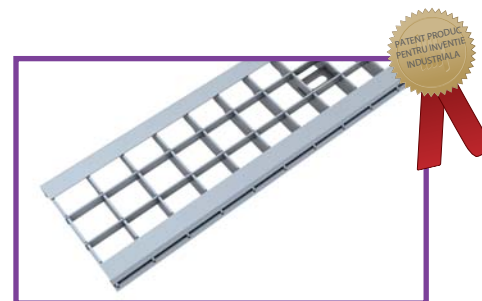
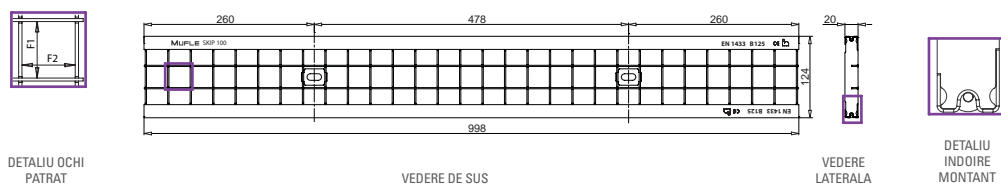

GRATAR FAGURE



COD	PRET €	MATERIAL	DIMENSIUNI L x l x h mm	GREUTATE kg	SUPRAFATA DRENARE dm ²	DESCHIDERE F1 x F2 mm	PRINDERE	
							bareta	zimt (fara fixare)***
507105		otel DD11 (1.0332)** zincat la cald	998 x 124 x 20	2,60	7,50	32,2 x 32,2		
507114		otel inox AISI 304* decapat						
507107		otel DD11 (1.0332)** zincat la cald	498 x 124 x 20	1,30	3,75			
507118		otel inox AISI 304* decapat						

* Clasificare conform normei americane ASTM.

** Clasificare conform normei EN 10111 (ed. martie 2000) si simbolistica conform normei EN 10027-1 (-2) (ed. septembrie 1993).

*** Sistem de blocare cu ajutorul unei protuberante continuta de rigola. Blocajul nu asigura fixarea gratarului pe rigola. Pentru obtinere unei prinderi stabile va sfatuim sa utilizati sistem de prindere cu bareta sau clip.

NOTA: Dimensiunile si greutatele se incadreaza in limite normale de toleranta.



GRATARE

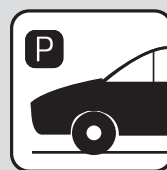

B 125

SKIP 100

APLICATII FONTA

Trotuare

Zone de stationare si parcare private

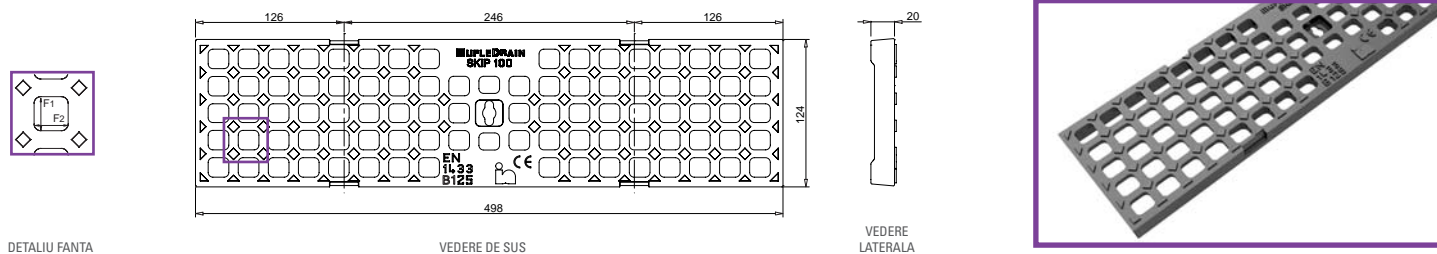

GRATAR FAGURE



COD	PRET €	MATERIAL	DIMENSIUNI L x l x h mm	GREUTATE kg	SUPRAFATA DRENARE dm ²	DESCHIDERE F1 x F2 mm	PRINDERE	
							bareta	fara fixare
507100		fonta nodulara GJS 500/7* vopsita cu vopsea apoasa	498 x 124 x 20	2,90	2,40	17,5 x 16,5		pana la clasa C250 conform normei EN 1433

* Clasificare conform normei EN 1563 (ed.martie 2004).

NOTA: Dimensiunile si greutatile se incadreaza in limite normale de toleranta.



GRATARE



C 250

SKIP 100

APLICATII FONTA

Cordone stradale
Centre istorice (trafic lent)
Zone de parcare
Parcari multietajate

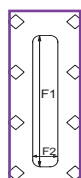

DETALIU FANTA

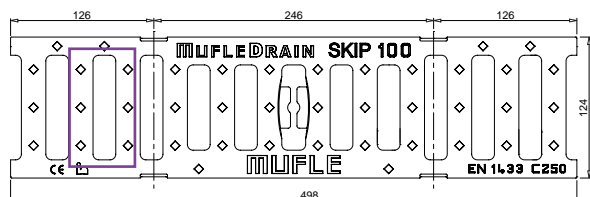

VEDERE DE SUS

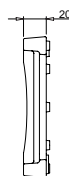

VEDERE LATERALA

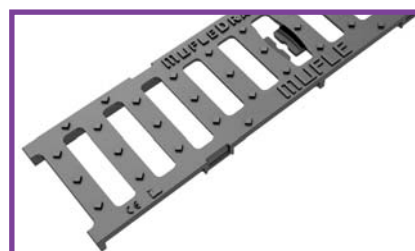

GRATARE CU FANTA 20 mm



COD	PRET €	MATERIAL	DIMENSIUNI L x l x h mm	GREUTATE kg	SUPRAFATA DRENARE dm ²	DESCHIDERE F1 x F2 mm	PRINDERE	
							bareta	fara fixare
507102		fonta nodulara GJS 500/7* vopsite cu vopsea apoasa	498 x 124 x 20	3,00	1,96	92,0 x 20,0		pana la clasa C250 conform normei EN 1433

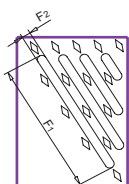

DETALIU FANTA

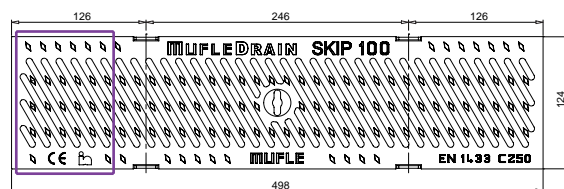

VEDERE DE SUS

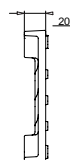

VEDERE LATERALA



GRATAR CU FANTA 6 mm



COD	PRET €	MATERIAL	DIMENSIUNI L x l x h mm	GREUTATE kg	SUPRAFATA DRENARE dm ²	DESCHIDERE F1 x F2 mm	PRINDERE	
							bareta	fara fixare
507101		fonta nodulara GJS 500/7* vopsite cu vopsea apoasa	498 x 124 x 20	3,10	1,87	95,0 x 6,0		pana la clasa C250 conform normei EN 1433

* Clasificare conform normei EN 1563 (ed.martie 2004).

NOTA: Dimensiunile si greutatile se incadreaza in limite normale de toleranta.



GRATARE



C 250

SKIP 100

APLICATII FONTA

- Cordoane stradale
- Centre istorice (trafic lent)
- Zone de parcare
- Parcari multietajate



DETALIU FANTA

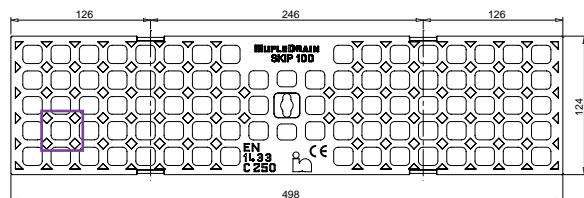

VEDERE DE SUS



VEDERE LATERALA



GRATAR FAGURE



COD	PRET €	MATERIAL	DIMENSIUNI L x l x h mm	GREUTATE kg	SUPRAFATA DRENARE dm ²	DESCHIDERE F1 x F2 mm	PRINDERE	
							bareta	fara fixare
507103		fonta nodulara GJS 500/7* vopsite cu vopsea apoasa	498 x 124 x 20	3,60	2,40	16,5 x 17,5		pana la clasa C250 conform normei EN 1433

* Clasificare conform normei EN 1563 (ed.martie 2004).

NOTA: Dimensiunile si greutatile se incadreaza in limite normale de toleranta.



GRATARE



SKIP 100

APLICATII PE-HD

- Zone rezidentiale
- Zone pietonale si/sau biciclisti
- Stadioane
- Sere
- Zone verzi

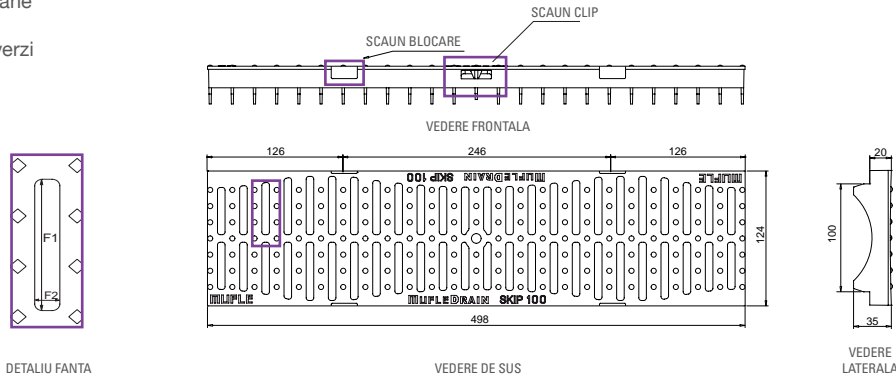

GRATAR CU FANTA 7 mm									
COD	PRET	MATERIAL	DIMENSIUNI L x l x h	GREUTATE	SUPRAFATA DE DRENAJ	DESCHIDERE F1 x F2	FIXARE		
	€		mm	kg	dm ²	mm	clip	zimt***	
507121		PE-HD negru	498 x 124 x 20	0,32	16,05	54,0 x 7,0			

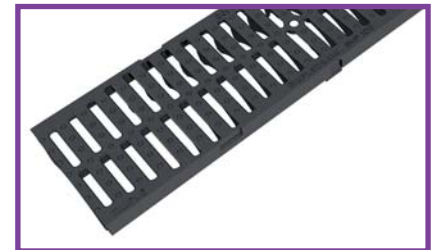
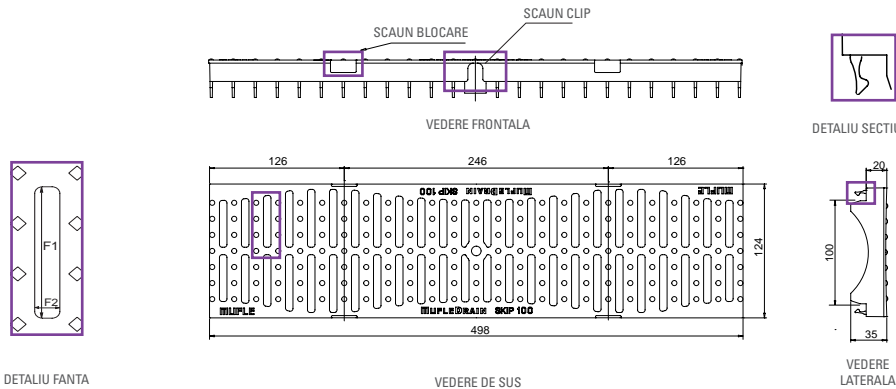

GRATAR CU FANTA 7 mm CU CARLIGE									
COD	PRET	MATERIAL	DIMENSIUNI L x l x h	GREUTATE	SUPRAFATA DE DRENAJ	DESCHIDERE F1 x F2	FIXARE		
	€		mm	kg	dm ²	mm	zimt***	carlig	
507126		PE-HD negru	498 x 124 x 20	0,32	16,05	54,0 x 7,0			

*** Sistem de blocare cu ajutorul unei protuberante continuta de rigola. Blocajul nu asigura fixarea gratarului pe rigola. Pentru obtinere unei prinderi stabile va sfatuim sa utilizati sistem de prindere cu bareta sau clip.

NOTA: Dimensiunile si greutatile se incadreaza in limite normale de toleranta.



GRATARE



PE-HD

SKIP 100

APLICATII PE-HD

Zone rezidentiale
 Zone pietonale si/sau biciclisti
 Stadioane
 Sere
 Zone verzi

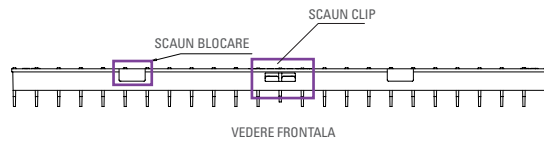

DETALIU FANTA

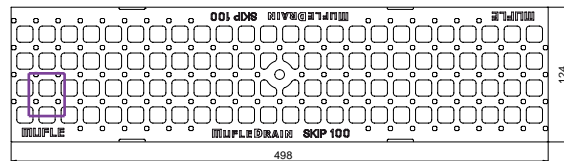

GRATAR FAGURE



COD	PRET €	MATERIAL	DIMENSIUNI L x l x h mm	GREUTATE kg	SUPRAFATA DE DRENAJ dm ²	DESCHIDERE F1 x F2 mm	FIXARE	
							clip	zimt***
507120		PE-HD negru	498 x 124 x 20	0,33	20,505	15,0 x 15,0		

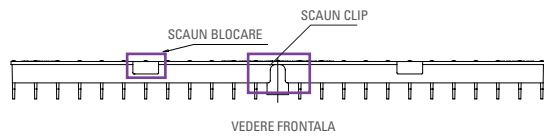

DETALIU FANTA

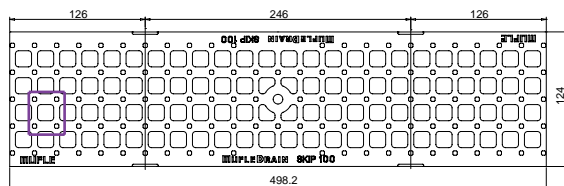

DETALIU SECTIUNE

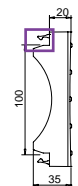

GRATAR FAGURE CU CARLIGE



COD	PRET €	MATERIAL	DIMENSIUNI L x l x h mm	GREUTATE kg	SUPRAFATA DE DRENAJ dm ²	DESCHIDERE F1 x F2 mm	FIXARE	
							zimt***	carlig
507127		PE-HD negru	498 x 124 x 20	0,33	20,505	15,0 x 15,0		



Gratarele SKIP din PE-HD nu sunt certificate in conformitate cu norma EN 1433 care, in prezent, nu prevede probe specifice la care sa fie supuse gratarele din material plastic. Testele efectuate de Mufle au concluzionat ca aceste gratare pot fi drfinite ca "Pietonale".

*** Sistem de blocare cu ajutorul unei protuberante continuta de rigola. Blocajul nu asigura fixarea gratarului pe rigola. Pentru obtinere unei prinderi stabile va sfatuim sa utilizati sistem de prindere cu bareta sau clip.

NOTA: Dimensiunile si greutatile se incadreaza in limite normale de toleranta.



ACCESORII

SKIP 100

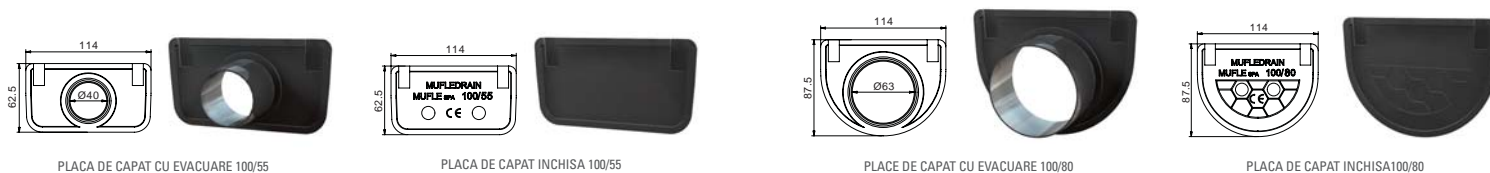

PLACA DE CAPAT CU EVACUARE 100/55

PLACA DE CAPAT INCHISA 100/55

PLACA DE CAPAT CU EVACUARE 100/80

PLACA DE CAPAT INCHISA 100/80

PLACI DE CAPAT

COD	PRET €	TIP	MATERIAL	UTILIZATE PENTRU RIGOLE	EVACUARI PREINSTALATE mm
700500		placa de capat cu evacuare	PE-HD	100/55	1 x Ø 40
700508		placa de capat inchisa	PE-HD	100/55	-
700501		placa de capat cu evacuare	PE-HD	100/80	1 x Ø 63
700509		placa de capat inchisa	PE-HD	100/80	-

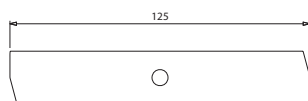

VEDERE DE SUS

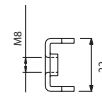

VEDERE LATERALA



KIT BARETE + SURUBURI

COD	PRET €	MATERIAL	UTILIZATA PENTRU GRATARE	SURUBURI	COMPOZITIE KIT PENTRU 1 ml
500421		otel zincat	SKIP otel zincat	M8 x 55 TBL combi	2 barete + 2 suruburi
500422		otel inox	SKIP otel inox	M8 x 55 TBL combi inox	2 barete + 2 suruburi
500423		otel zincat negru	SKIP fonta nodulara	M8 x 55 cap negru hexagonal	2 barete + 2 suruburi

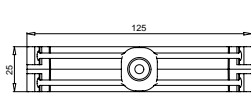

VEDERE DE SUS

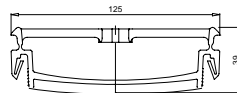

VEDERE LATERALA



KIT CLIP

COD	PRET €	MATERIAL	UTILIZAT PENTRU GRATARE	COMPOZITIE KIT / 1 ml
510212		PE-HD	SKIP stantat otel zincat si inox SKIP PE-HD	2 clip

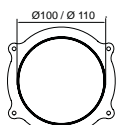

VEDERE DE SUS

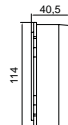

VEDERE LATERALA



KIT RACORD EVACUARE + SURUBURI

COD	PRET €	MATERIAL	UTILIZAT PENTRU RIGOLE	DIAMETRU mm	COMPOZITIE KIT / 1 ml
506114		PE-HD	100/55 - 100/80	Ø 100	1 racord evacuare Ø 100 + 4 suruburi
506115		PE-HD	100/55 - 100/80	Ø 110	1 racord evacuare Ø 110 + 4 suruburi

NOTA: Dimensiunile si greutatele se incadreaza in limite normale de toleranta.



PIESE SPECIALE

SKIP 100

COLTAR STANGA

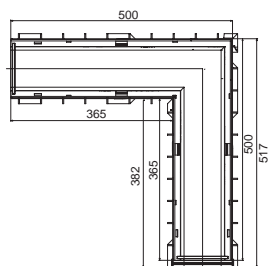

SKIP 100

COD	PRET €	MODEL
707100		100/80
707101		100/55

COLTAR DREAPTA

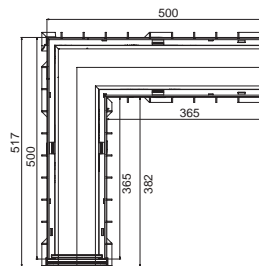

SKIP 100

COD	PRET €	MODEL
707102		100/80
707103		100/55

TEU STANGA

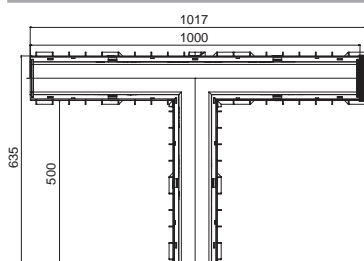

SKIP 100

COD	PRET €	MODEL
707104		100/80
707105		100/55

TEU DREAPTA

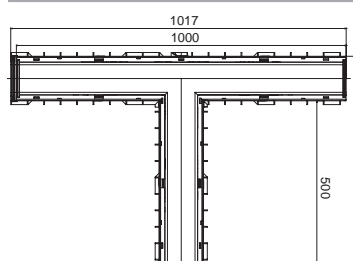

SKIP 100

COD	PRET €	MODEL
707106		100/80
707107		100/55

CRUCE

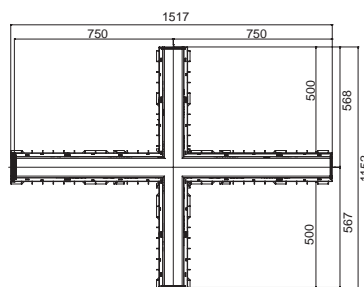

SKIP 100

COD	PRET €	MODEL
707108		100/80
707109		100/55

NOTA: Dimensiunile si greutatele se incadreaza in limite normale de toleranta.